

# FAB GLASS AND MIRROR

www.fabglassandmirror.com

## Installation Instructions

Customer Service  
US: +1 888-474-2221

### Mirror Tiles

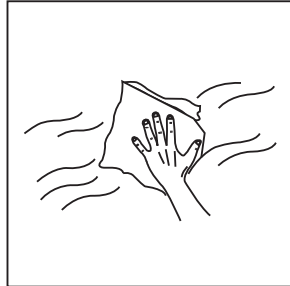
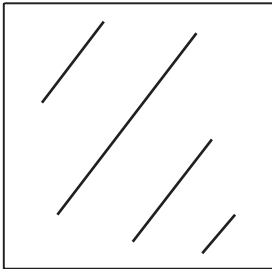
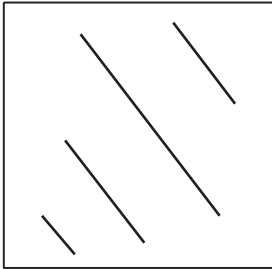
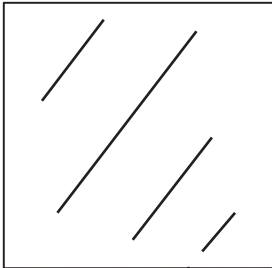
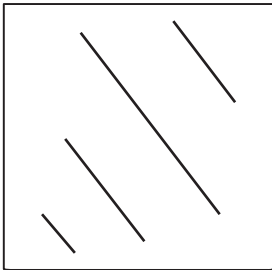

**Step 1:**  
**Prepare the Surface**

Wipe the wall surface with a dry cloth to remove dust and dirt. Wipe the back of the mirror tiles with a dry cloth to ensure proper adhesion.

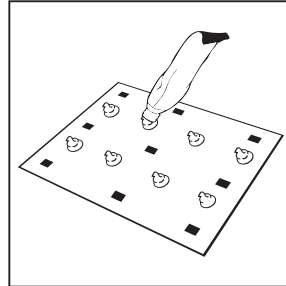

**Step 2:**  
**Position the Adhesive**

Take double-sided tape and adhesive glue and attach it to the back of the mirror tile. Place adhesive on all four corners and in the center to ensure even sticking.

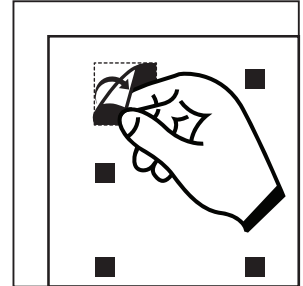

**Step 3:**  
**Uncover the Adhesive and Position the Mirror**

Remove the protective layer from the adhesive tape to expose the sticky side. Align the mirror tile carefully on the wall. Ensure it is straight and aligned with the surrounding tiles or the intended layout.

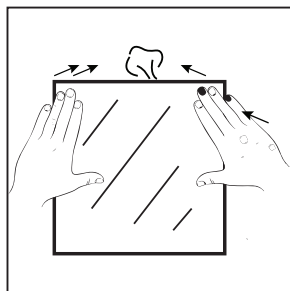

**Step 4:**  
**Stick the Mirror Tile**

Press the mirror tile firmly onto the wall. Apply even pressure on all sides to ensure proper adherence.



**PAY ATTENTION:**

Ensure the wall is flat, clean, and dry. Suitable surfaces include doors, glass, tiles, painted walls, or metal. Avoid uneven, rough wood, brick walls, wallpaper, or ash-falling walls.



**HOW TO REMOVE:** If you need to remove the adhesive, use a hair dryer to heat the adhesive surface. This will make it easier to peel off.



**Note:** The adhesive is not reusable. If you need to change the installation location, additional adhesive can be purchased.